

100 ° Flat Head

Screw Size	Offset Cruciform	Ribbed Offset Cruciform	Reference Penetration inch/mm	Diameter inch/mm	Length inch/mm
2	2OCF-1-3-M		.031/.79	.437/11.11	1.000/ 25.40
4	4OCF-1-3-M		.040/1.02	.437/11.11	1.000/ 25.40
6	6OCF-1-3M	6OCFR-2101	.050/1.27	.437/11.11	1.000/ 25.40
8	8OCF-1-3M	8OCFR-2101	.059/1.50	.563/ 14.29	1.000/ 25.40
10	10OCF-1-3M	10OCFR-2101	.068/1.73	.563/ 14.29	1.000/ 25.40
1/4	1/4OCF-1-3M	1/4OCFR-2101	.089/2.26	.875 / 22.23	1.000/ 25.40
5/16	5/16OCF-1-3M	5/16OCFR-2101	.096/2.44	.875 / 22.23	1.000/ 25.40
3/8	3/8OCF-1-3M	3/8OCFR-2101	.103/2.62	1.000 / 25.40	1.000/ 25.40

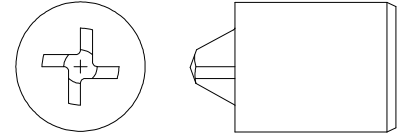

82 ° Flat & Flat Fillister Head

Screw Size	Offset Cruciform	Ribbed Offset Cruciform	Reference Penetration inch/mm	Diameter inch/mm	Length inch/mm
2	2OCF-1-82		.035/.89	.437 / 11.11	1.000/ 25.40
4	4OCF-1-82		.045/1.14	.437 / 11.11	1.000/ 25.40
6	6OCF-1-82	6OCFR-2103	.055/1.40	.437 / 11.11	1.000/ 25.40
8	8OCF-1-82	8OCFR-2103	.065/1.65	.563 / 14.29	1.000/ 25.40
10	10OCF-1-82	10OCFR-2103	.076/1.93	.563 / 14.29	1.000/ 25.40
1/4	1/4OCF-1-82	1/4OCFR-2103	.099/2.51	.875 / 22.23	1.000/ 25.40
5/16	5/16OCF-1-82	5/16OCFR-2103	.098/2.49	.875 / 22.23	1.000/ 25.40
3/8	3/8OCF-1-82	3/8OCFR-2103	.118/3.00	1.000 / 25.40	1.000/ 25.40

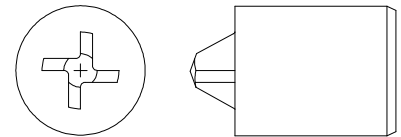

Pan Head

Screw Size	Offset Cruciform	Ribbed Offset Cruciform	Reference Penetration inch/mm	Diameter inch/mm	Length inch/mm
2	2OCF-4-4M		.025/.64	.437/ 11.11	1.000/ 25.40
4	4OCF-4-4M		.032/.81	.437 / 11.11	1.000/ 25.40
6	6OCF-4-4M	6OCFR-2107	.039/.99	.437 / 11.11	1.000/ 25.40
8	8OCF-4-4M	8OCFR-2107	.047/1.19	.563/ 14.29	1.000/ 25.40
10	10OCF-4-4M	10OCFR-2107	.054/1.37	.563/ 14.29	1.000/ 25.40
1/4	1/4OCF-4-4M	1/4OCFR-2107	.059/1.50	.875/ 22.23	1.000/ 25.40
5/16	5/16OCF-4-4M	5/16OCFR-2107	.086/2.18	.875/ 22.23	1.000/ 25.40
3/8	3/8OCF-4-4M	3/8OCFR-2107	.103/2.62	1.000 / 25.40	1.000/ 25.40

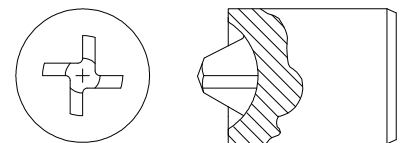

1. Punch materials:

- M2 at RC 62-64
- M42 at RC 63-65

2. Punches available with headmarking and company logo. Please specify when ordering.

3. PVD Coatings available for cold & hot heading applications.